



LANGUAGE • FR/EN

moving forward in every field

INJECTION PARTS

▶▶ ACCESSORIES

Catalogue - First published 1998

www.bepcoparts.com

Member of **TVH** 

ABOUT BEPCO

Bepco Group is a worldwide leading supplier of parts and accessories for agricultural tractors and machinery.

With over 360 employees Bepco Group has subsidiaries in Belgium, Netherlands, France, Germany, Spain and UK and is also present in Australia, New Zealand, South Africa and Brazil.

Bepco Group is a truly global company with customers in over 100 countries worldwide and sales outside Europe contributing to over a third of revenues.

We offer our network of distributors and dealers :

- ▶▶ Original Equipment Supplier and other industry leading brands
- ▶▶ More than 20,000 m² of warehousing
- ▶▶ More than 80,000 stock items
- ▶▶ Technological knowledge from industry experts
- ▶▶ Same day shipment, next day delivery in many markets

Bepco Group is also a member of TVH, the all-round supplier of quality parts and accessories for material handling, industrial vehicles and agricultural equipment.

INJECTION PARTS

**POMPE D'ALIMENTATION ELECTRIQUE - ELECTRICAL FEED PUMP -
ELEKTRISCHE KRAFTSTOFFFÖRDERPUMPE - ELECTRISCHE OPVOERPOMP -
BOMBA GAS OIL Y ELECTRICAL**

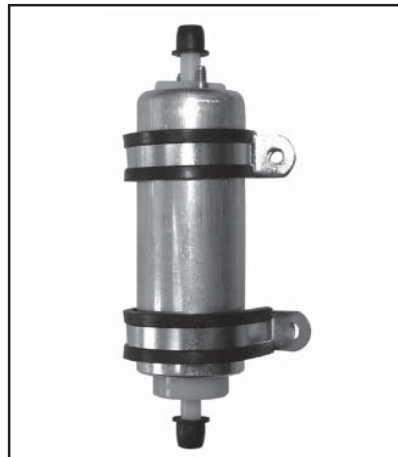

	Ref.	Description Beschreibung Omschrijving Descripción
Universel	40/100-117	12V Si pression = 0, débit 150l/h If pressure = 0, flow 150l/h Falls druck = 0, durchfluss 150L/std Wanneer druk = 0, debiet 150L/Hr Si presión = 0, flujo 150l/h Si pression = 0,5 Bar, débit 90l/h If pressure = 0,5 Bar, flow 90l/h Falls druck = 0,5 Bar, durchfluss 90L/std Wanneer druk = 0,5 Bar, debiet 90L/Hr Si presión = 0,5 Bar, flujo 90l/h Peut être utilisé avec du Bio-carburant (20%) Can be use with Bio-fuel (20%) Kann mit Bio-Diesel verwendet werden (20%) Kan met bio-diesel gebruikt worden (20%) Puede ser utilizado con la bio-diesel (20%)

Les références des pièces sont indicatives.
Nos pièces ne sont pas d'origine.

Part numbers are quoted for reference purposes only.
Our parts and accessories are not original.



ADDITIF POUR GASOIL - TOEVOEGSEL VOOR DIESELOLIE

STANADYNE Performance Formula



ADDITIF POUR GASOIL

Seuls, les additifs de Stanadyne :

- Sont fabriqués par un spécialiste de matériel d'injection diesel
- Sont approuvés par des constructeurs de véhicules et de moteurs diesel
- Ont donné les meilleurs résultats par des essais en laboratoires indépendants

TOEVOEGSEL VOOR DIESELOLIE

De additieven van Stanadyne zijn (hebben) enkel en alleen :

- vervaardigd door een vakman voor dieselinjectie materiaal
- goedgekeurd door autoconstructeurs
- de beste resultaten behaald bij tests in onafhankelijke laboratoria

Réf. Ref	Conditionnement Verpakking	Vol. traité Behandeld vol.
65/9608-1	235 ml	120 L
65/9608-2	470 ml	235 L
65/9608-3	1.9 L	960 L

Séparation de l'eau : Contient des dé-émulsifiants qui rendent plus efficace la séparation de l'eau du diesel par les filtres séparateurs

Economies : Réduit la consommation de diesel et le coût d'entretien. Améliore la souplesse du moteur.

Stockage : Stabilise le diesel. Limite la dégradation.

Entretien : Améliore la lubrification des systèmes d'injection. Supprime les gommages et calamines.

Protection hiver : Abaisse la température de figeage du diesel. Améliore le démarrage par grand froid.

Environnement : Participe à la réduction du nombre de particules et des émissions de fumée des moteurs diesel jusqu'à 49%.

Usage : Les nouvelles technologies de système d'injection diesel ont toutes été testées et approuvées pour l'utilisation du "Performance Formula".

Homologation : Ce produit est recommandé par des fabricants de moteurs et véhicules. Il a été testé et approuvé par General Motors, VW, John Deere, Ford/Navistar et bien d'autres.

Waterafscheiding : Bevat verdunningsproducten die het afscheiden van het water door de filters/drogers nog efficiënter maken

Besparing : Reduceert het verbruik van dieselolie alsook de onderhoudskosten. Maakt de motor soepeler.

Opslag : Stabiliseert de dieselolie. Beperkt de degradatie.

Onderhoud : Verbetert de smering van injectiesystemen. Verwijdert gom en kras.

Bescherming winter : Verlaagt stollingstemperatuur van de dieselolie. Vergemakkelijkt het starten

Milieu : Zorgt voor een afname van stofdeeltjes en rookuitstotingen van dieselmotoren tot 49%

Gebruik : "Performance Formula" werd voor het gebruik van de nieuwste dieseltechnologieën getest en goedgekeurd.

Homologatie : Dit product wordt door motoren autofabrikanten aanbevolen. Het werd door General Motors, VW, John Deere, Ford/Navistar en vele anderen getest en goedgekeurd.

Les références de pièces sont indicatives.
Nos pièces ne sont pas d'origines

Parts numbers are quoted for reference purposes only.
Our parts and accessories are not original



"THE RELIABLE SERVICE"



DIESEL PARTS

Cigarettes d'allumage pour le démarrage des moteurs Diesel
 Auto-Starter for diesel engines
 Aanmaakkaarsen voor het starten van dieselmotoren
 Selbstzünder zum Anlassen von Dieselmotoren
 Encendedor automático para el arranque de los motores diesel



Part N°	Ø	Qté - Qty - Hœv. - Menge - Cantidad
70/1524-3	4 mm	100
70/1524-4	5 mm	
70/1524-5	6 mm	
70/1524-6	7 mm	
70/1524-7	8 mm	

Les références des pièces sont indicatives.
 Nos pièces ne sont pas d'origine.

Part numbers are quoted for reference purposes only.
 Our parts and accessories are not original.



"THE RELIABLE SERVICE"



TURBO PARTS

Nouvelles disponibilités en turbos pour les marques suivantes :
New availabilities on turbo for the following tractors :
Neue verfügbare Turbomotoren für folgende Marken :
Nieuwe beschikbare turbomotoren voor volgende merken :
Nueva disponibilidad de turbos para los tractores siguientes :

**BELARUS - CASE-IH - CLAAS - DRONINGBORG - FIAT/FORD (NEW HOLLAND) -
FORTSCHRITT - JOHN DEERE - LANDINI - MASSEY FERGUSON - RENAULT -
STEYR - URSUS - VALMET/VOLVO - ZETOR**

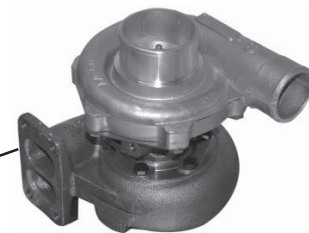
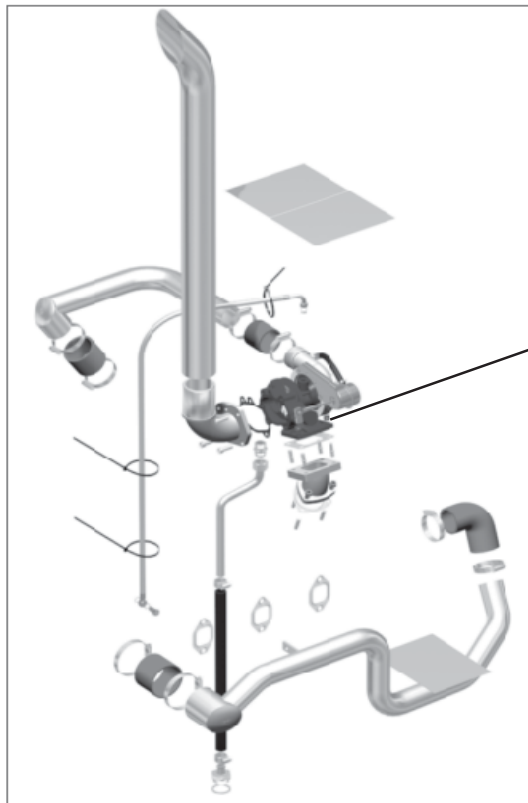

Consultez nous pour tout renseignement complémentaire sur cette nouvelle gamme
Consult us for further information
Fragen Sie uns für nähere Angaben zu diesem Programm
Raadpleeg ons voor nadere inlichtingen omtrent dit gamma
Consultenos si deseán informacion adicional

Les références des pièces sont indicatives.
Nos pièces ne sont pas d'origine.

Part numbers are quoted for reference purposes only.
Our parts and accessories are not original.



“THE RELIABLE SERVICE”

Nez d'injecteurs / Injection nozzles

Nez d'injecteurs

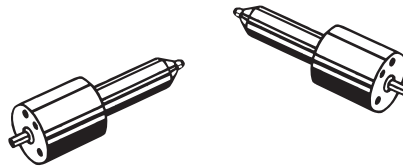

Injection nozzles

Tracteurs Tractors	Pression Flow	Ref. Cde Order N°	N° injecteur N° inj. nozzle
AVTO-BELARUS			
Mot. 7B80, MIZ, MVZ Engines		27/78000 (11-1112110A, BR.80,4x0,29)	BR80
Mot. AM3 Engine		27/78001 (BR90,3x0,30)	BR90
Mot. MAZ.500 Engine		27/78002 (4x0,39, 07-79236, 236-1111074A)	07-79-236
Mot. MTZ.50 Engine		27/70962 (16C42, DN8S2)	DN852
CASE-IH (David Brown)			
780, 880, 885, 900, 990, 995, 996, 1190, 1194, 1200, 1210, 1212, 1290, 1294, 1390, 1394, 1410, 1412, 1490, 1494, 1594, 1690, 1690 T, 1694		DB.70119	BDLL140S6592 BDLL140S6417
CASE-IH (Europe)			
D.212, D.214, D.215, D.217F, D.219, D.320, D.322, D.324, D.326, D.430, D.432, D.439, D.440		R.718383	DNOSD1550
Mot. D.155, D.179, D.206, D.310, 433, 533, 633, 644, 733, 955 (↔ 10/79) Engines		25/3218249	DLLA150S716
353, 383, 423, (Mot. D.155 Engine) 12/67 ↔ 2/75, 453 (Mot. D.155 Engine) 7/71 ↔ 3/75, 523 (Mot. D.179 Engine) 12/67 ↔ 12/71, 553 (Mot. D.179 Engine) 3/72 ↔ 1/74, 554 (Mot. D.179 Engine) 7/71 ↔ 3/75, 624 (Mot. D.206 Engine) 12/67 ↔ 12/71, 633 (Mot. D.179 Engine) ↔ 4/76, 654 (Mot. D.206 Engine) 3/72 ↔ 12/74, 644, 724, 824, 946	205 bars	R.3055426	433270120 DLL150S2641
433, 533, 633, 644, 733 (Mot. D.155, D.179, D.206 Engines) 11/79, 955 (Mot. D.310 Engine) 11/79 ↔	225 bars	25/3218248	433271838 DLLA150S836
544, 574 (Mot. D.239 Engine) 1/72 ↔ 7/74, 724, 824, 834 (Mot. D.239, D.246 Engines) ↔ 2/74, 1046, 1246, 744, 844, 844S	205 bars	R.3055428	433271180 DLLA150S417
743, 745 (Mot. D.239 Engine) 9/80 ↔, 744 (Mot. D.239 Engine) 5/79 ↔ 8/80, 844, 844S, (Mot. D.246, D.268 Engines) 5/79 ↔, 833, 833S, 955, 1055 (Mot. D.358 Engine) 11/79 ↔, 1246 (Mot. DT.358 Engine) 5/79 ↔, 956, 956XLA, 1056XLA	225 bars	25/3218251	433271849 DLLA150S815 DLLA150S690

Non original replacements

(Ed.4) 07/98

IN - 1

“THE RELIABLE SERVICE”
Nez d'injecteurs / Injection nozzles

Tracteurs Tractors	Pression Flow	Réf. Cde Order N°	N° injecteur N° inj. nozzle
1255, 1455 (Mot. DT.358, DT.402 Engines) 9/80 ⇄	225 bars	25/3218255	433271834 DLLA150S843
MAXXUM 5120		0433171074	433171074 DLLA155P74
MAGNUM 7120, 7130	205 bars	0433171104	433171104 DLLA150P115
MAGNUM 7140	205 bars	0433171121	433171121 DLLA150P133
CASE-IH (England)			
250, 275, 276, 354, 374, 384, 414, 434, 444		25/117-51 (3040871R91)	434250056 BDN4SD6299
385, 395, 484, 495, 584, 585, 595 (+XL)	225 bars	25/117-53 (3218248R2)	433271838 DLLA150S836
684, 685, 695, 784, 785, 795, 884, 885, 895, 995 (+XL)	225 bars	25/117-52 (3218251R2)	433271849 DLLA150S815
DEUTZ-FAHR			
D.2506, D.3006, D.4506, D.5006, D.5206 (FL.912) 1/68 ⇄ 6/78		21/N.71116	433271172 DLLA149S394
D.2506, D.3006, D.4506, D.5006, D.5206 (FL.912) 7/78 ⇄		21/N.71191	433271376 DLLA149S774
D.5506, D.6006, D.7006 (FL.912) ⇄ 8/74, D.6206, D.6806, D.7206, D.8006, D.10006 (FL.912) 9/74 ⇄ 6/78		21/N.71116	433271162 DLLA149S394
D.6206, D.6806, D.7206, D.8006, D.10006 (FL.912) 7/78 ⇄		21/N.71191	433271376 DLLA149S774
D.7506, D.9006 1/68 ⇄ 4/70		21/N.71116	433271162 DLLA149S394
D.4007, D.4507, D.4807, D.5207, D.6207, D.6807, D.7207, D.7807 (FL.912), DX.36,DX.50		21/N.71191	433271376 DLLA149S774
DX.85, DX.90, DX.110 (FL.913) 2/78 ⇄ 6/78		21/N.71116	433271162 DLLA149S394
DX.85, DX.90, DX.110 (FL.913) 7/78 ⇄		21/N.71191	433271376 DLLA149S774
D.13006 (FL.912), DX.140, DX.160 (FL.913) 5/72 ⇄ 6/78		21/N.71129	433271223 DLLA149S490
D.13006 (FL.912), DX.140, DX.160 (FL.913) 7/78 ⇄		21/N.71192	433271377 DLLA149S775
Non original replacements			

IN - 2

(Ed.4) 03/99

"THE RELIABLE SERVICE"
Nez d'injecteurs / Injection nozzles

Tracteurs Tractors	Pression Flow	Réf. Cde Order N°	N° injecteur N° inj. nozzle
FENDT			
M.W.M. D.208, 225, 226, 227, 325		22/71027	433270114 DLL150S393
Deutz FL.912		21/N.71191	433271376
Série "300" Serie		XF.433271 (433.271.846.019)	DLLB150S821
Mot. M.W.M. D.226B Engine , Tract. 614, 615		0433.271.790	DLLA151S972
309LSA, 612LSA, ...		0433.271.828 (F.131.204.710.200)	DLLB151S854
FIAT AGRI (+ Someca)			
Anciens tracteurs / Old Tractors		FA.770945	DLL150S51F
350, 450, 550, 900 (Alésage / boring 95mm)		FA.767104	DLL145S50F
400, 450, 500, 600, 1000 (Alésage / boring 100mm)		FA.769203	DLL145S60F
480, 488, 540, 640, 466, 566, 666, 580, 780, 880, 880-5, 980, 1180,1280, 1380		FA.4760843	DLL140S64F
650, 750, 850		FA.4763930	DLL145S54F
1580, 1880, 160-90, 180-90		FA.4750505	DLL145S73F
45-66, 55-66, 70-66, 55-90, 70-90, 100-90		FA.4792443	DLLA124S1001
60-66, 60-90, 80-90, 90-90, 115-90, 130-90, 140-90		FA.4800030	DLLA136S1000
FORD (New Holland)			
Dexta (3/144)		171/8678	BDL110S6133
Super-Dexta (3.152)		180/9942	BDL110S6610
Major, Super Major (52↔4/57)		24/117-13 (81714498, EIADDN993149)	BDLL150S6159
2000, 2300		180/6140	OLL150S6443
3000, 5000 (SIMMS ↔ 3/68 & C.A.V.), Major, Super Major (4/57 ↔ 8/58)		182/5598	BDLL150S6571
3000, 5000 (SIMMS 4/68 ↔)		183/4304	BDLL140S6422
2600, 2310		390/5776	BDLL150S6698
2610, 2810, 2910		392/7749	BDLL150S6029
4000		181/3344	OLL150S6476
Non original replacements			

(Ed.4) 07/98

IN - 3

“THE RELIABLE SERVICE”
Nez d'injecteurs / Injection nozzles

Tracteurs Tractors	Pression Flow	Réf. Cde Order N°	N° injecteur N° inj. nozzle
4100, 3600, 3610, 5600, 5610, 5700 (75↔9/80)		390/0058	OLL150S6665
4110, 7810, 7910		24/117-29 (83927750, EINN9E527BA)	BDLL150S6828
4600, 6600, 6610, 6700, 6710 (75↔9/80)		390/0061	OLL150S6666
4610		391/7472	OLL150S6774
3600, 3610, 5600, 5610, 5700 (10/80↔)		391/9131	BDLL150S6780
6600, 6610, 6700, 6710 (10/80 ↔), 8000, 8200, 8210, 8530, 8600, 8630, 8700, TW.5, TW.10, TW.15		391/9132	BDLL150S6790
7000, 9000, 9600, 9700, TW.20, TW.30		182/1327	BDLL150S6552
7600, 7610, 7700, 7710 (75 ↔ 9/80)		390/0064	BDLL150S6667
7600, 7610, 7700, 7710 (10/80 ↔), 8730, 8830, TW.25, TW.35		391/9155	BDLL150S6781
HÜRLIMANN			
Selon applications / <i>Depending fittings</i>		29/71199	433271855 DLLA150S806
H358, 362, 468, 478, 488T, 4105		29/4729-100	DDLA150S925 DDLA150S690
JOHN DEERE			
310, 510, 710, 4040, 4040S, 4230			
Séries 20, 30, 40 & 50 Series Sans Turbo / <i>Less Turbo</i>	210 bars	26/117-44 (AR.89564, AR.89563)	27333
Séries 40 & 50 Series (↔ 753261) Avec Turbo / <i>With Turbo</i>	210 bars	26/117-45 (AR.90024, AR.90023)	27336
Série 50 Serie (753262 ↔) Avec Turbo / <i>With Turbo</i>	210 bars	26/117-46 (RE.31757, RE.37503)	26993
3300, 3300X, 3400, 3400X, 6100, 6200, 6300, 6400, 6600, 6800, 6900	210 bars	26/117-47 (RE.36939, RE.38087)	28485 28484
7600, 7700, 7800	210 bars	26/117-48 (RE.48786, RE.44508)	29279
LAMBORGHINI			
Selon applications / <i>Depending fittings</i>		29/71095 (247290100)	433271079 DLLA160S255
674-70, 874-90, 774-80, 600, 700, 1106, 1306, 105, 775F		29/4729-100	DDLA150S925 DDLA150S690
Non original replacements			

“THE RELIABLE SERVICE”
Nez d'injecteurs / Injection nozzles

Tracteurs Tractors	Pression Flow	Réf. Cde Order N°	N° injecteur N° inj. nozzle
LANDINI			
Mot. 3.152, 4.203 Engines		30/2646607 (31990)	BDL110S6133
Mot. D3.152, D4.203 Engines		30/2646676 (26461311)	BDLL150S6372
Mot. D3.152 Engines		30/2646825 (1446896M1)	BDLL150S6602
Mot. 4.212, 4.236 Engines		30/2646689 (1446702M1, 26461317)	BDLL150S6555
Mot. 4.236, 4.212 Engines		30/2646842 (1447227M1, 2645C.609)	BDLL150S6705
Mot. 4.248 Engine		30/2646690 (1446703M1, 2645C611)	BDLL150S6556
Mot. 6.354-1 Engine		30/2646679 (883258M91)	BDLL150S6472
Mot. 6.354-4 Engine		30/2646844 (1447269M91, 2645C.612)	BDLL150S6730
Mot. T6.354-4 Engine		30/2646845 (1447391M1, 26461304)	BDLL150S6737
MASSEY-FERGUSON			
FE.35 (4 cyl. 23c)		BDN.12SP.6290	BDN.12SP.6290
MF.25, 825, MF.30, 130 (4107)		30/2646724	BDN4SD6769
MF.35 (A3 152) ⇄ 1944524, MF.65 (A4.192) 2426548 ⇄		30/117-11	
MF.35 (A3 152) 1944525 ⇄, MF.65 (A4.203)		30/2646607	BDL110S6133
MF.65 (A4.192) ⇄ 2426547		30/117-2	
MF.65, 765, 865 (AD4.203), MF.135 (AD3.152) ⇄ 203993D		30/2646676	BDLL150S6372
MF.135 (203994D ⇄), 230, 240		30/2646848	BDLL150S6743
MF.148, 250 (AD3.152)		30/2646825	BDLL150S6602
MF.155, 158, 165 (AD4.203)		30/2646688	BDLL150S6554
MF.165 (A4.212), 165 MK2		30/2646689	BDLL150S6555
165 (A4.212), 168, 175, 265, 275 (A4.236)		30/2646842	BDLL150S6705
178, 285, 188, 285 (A4.248)		30/2646690	BDLL150S6556
290 (A4.248)		30/2646826	BDLL150S6600
285, 298 (A4.318)		30/2646824	BDLL150S6599
Non original replacements			

(Ed.4) 03/99

IN - 5

“THE RELIABLE SERVICE”
Nez d'injecteurs / Injection nozzles

Tracteurs Tractors	Pression Flow	Réf. Cde Order N°	N° injecteur N° inj. nozzle
340 (AD3.152)		30/2646848	BDLL150S6743
342, 350 (AT3.152)		30/117-35	2645K604
352, 355, 360 (AT3.152)		30/117-36	2645K603
362, 365, 372, 375 (A4.236)		30/2646842	BDLL150S6705
390 (A4.248)		30/2646826	BDLL150S6600
390T, 398 (AT4.236)		30/117-37	2645K602
399 (A6.354.4)		30/117-42	2645A604
550 (AD3.152)		30/2646825	BDLL150S6602
565, 575, 675 (A4.236)		30/2646842	BDLL150S6705
590, 690 (A4.248)		30/2646826	BDLL150S6600
595, 698 (A4.318)		30/2646824	BDLL150S6599
698T (AT4.236)		30/117-37	2645K602
699 (A6.354.4)		30/2646844	BDLL150S6730
1080, 1085 (A4.318)		30/2646824	BDLL150S6599
1100, 1200 (A6.354, 354.1)		30/2646679	BDLL150S6472
1250, 2620, 2625, 2640, 2645 (A6.354.4)		30/2646844	BDLL150S6730
2680, 2685 (AT6.354.4)		30/2646845	BDLL150S6737
2720, 2725 (AT6.354.4)		30/117-43	2645A603
3050 (A4.236)		30/2646842	BDLL150S6705
3060 (AT4.236)		30/2646826	BDLL150S6600
3065, 3070 (AT4.236)		30/117-37	2645K602
3080 (A6.354.4)		30/117-42	2645A604
3090, 3610 (A6.354.4)		30/2646844	BDLL150S6730
3630 (AT6.354.4)		30/2646845	BDLL150S6737
3650 (AT6.354.4)		30/117-43	2645A603
RENAULT - DMA			
D.16, N.73JR, N.70, D.35, Sup.6, Mot. AKD.112, 311Z <i>Engines</i>		RR.40126	DONSD126
Super 7 (P3/152) Roto-diesel		RR.49167	BDL110S6267
Sup.4, Sup.5, R.78, 385 Master 2 (Bosch)		RR.40021	DNOSO21
Non original replacements			

"THE RELIABLE SERVICE"
Nez d'injecteurs / Injection nozzles

Tracteurs Tractors	Pression Flow	Réf. Cde Order N°	N° injecteur N° inj. nozzle
Renault 55, 57 (Bosch)		RR.71022	DLL18S353
Mot. "M.W.M." Engine , D.225, D.226, D.227, D.322		RR.71027	DLL150S393 RDLL150S6501
Mot. "M.W.M." Engine , D.225, D.226, D.227, D.322		RR.70201	BDLL150S6501
Mot. "M.W.M." Engine , D.226, D.227, TD.228		RR.70202	BDLL150S6741
Mot. D.226B Engine , Tract. 155-54		0433.271.790	DLLA151S972
SAME			
Selon applications / Depending fittings		29/71095 (2.472.901.00)	433271079 DLLA160S255
Drago 100, Saturno, Buffalo 120, Corsaro		29/71233 (2.472.905.00)	DLLA160S608
Laser 150, Galaxy 170, Hercules 160		29/4729-90	DLLA150S830
Explorer 60, 70, 75, 80, 90, Aster 60, Frutteto 60, 75, Vigneron 62, 75, Antares 110, 130, Silver		29/4729-100	DDLA150S925 DLLA150S690
STEYR			
540, 545, 650, 658, 760, 768	220/222 bars	SDP.111	433271164
430, 870, 980, 988,1 090, 1108, 1111, 1200, Dutra 1300, 8140, 8160	220 bars	SDP.112	433271205
VALMET			
361, 500, 565		V.70070	BDLL150S6429
505, 505-4, 605, 605-4, 705, 705-4, 805, 805-4		V.71198	DLLA150S804
VOLVO-BM			
350		VBM.71176	DLLA150S720
Non original replacements			

(Ed.3) 03/99

IN -7

“THE RELIABLE SERVICE”
Nez d'injecteurs / Injection nozzles

Tracteurs Tractors	Pression Flow	Réf. Cde Order N°	N° injecteur N° inj. nozzle
ZETOR			
2511, 3511, 4511, 5511, 5545, 5611, 5645, 5647, 4712, 4718, 5711, 5718, 5745, 5745, 5748, 2011, 3011, 4011, 8011, 8045 (1001 ⇄ 24292), 12011, 12045 (1001 ⇄ 1974), 10011, 10045, 16045		ZR.559 (930559, 985512, 80250903) (5x0,25)	DOP150S525-53, DOP150S525-1402
6711, 6718, 6745, 6748		ZR.560 (933499) (6x0,25)	DOP160S625-4343
3320, 3340, 4320, 4340, 5320, 5340(H), 6320, 6340, 5011, 6011, 6045, 7011, 7045 (H), 5211, 5245, 6211, 6245, 7211, 7245(H), 7711, 7745, 4911, 6911, 6945, 5911, 5945		ZR.558 (930558,933385, 933390)	DOP160S430-1436, DOP150S335-4359, DOP160S430-4355
8011, 8045(28248 ⇄ 38087), 12011, 12045(3742 ⇄ 6720)		93009308 (93009832,930093)	DOP150S428-4357
8111, 8145, 12111, 12145, 8211, 8245, 11211, 11245, 12211, 12245		ZR.310 (93009310)	DOP150S430-1439
9111, 9145, 10111, 10145, 14145, 16145, 9211, 9245, 10211, 10245, 14245, 16245		ZR.309 (93009309)	DOP150S535-1417
7520, 7540, 8520T, 8540T, 9520, 9540, 9520T, 9540T, 10520T INT., 10540T INT.		ZR.628 (933628)	DOP150S428-4104

Non original replacements

IN - 8

(Ed.3) 05/98

"THE RELIABLE SERVICE"

BOUGIES DE PRECHAUFFAGE

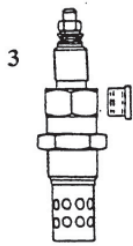

**BOUGIES DE PRECHAUFFAGE
OFFRE SPECIALE**

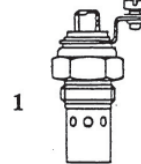
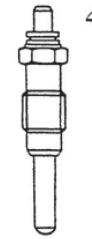

Marque	Réf. Commande	Fig.	Applications
DAVID-BROWN	D.928523	1	Pour toutes applications
CASE-IH (EUROPE)	R.20601	4	M.18 x 1,5
CASE-IH (ENGLAND)	D.928523	1	385, 395, 484, 485, 495, 584, 585, 595, 684, 685, 695
	03112305R91	2	784, 785, 795, 884, 885, 895 454, 474, 574, 674
DEUTZ	K.100/222	4	D.25, D.30, D.40, D.4055, D.2505, D.3005, D.4005, D.4505
	K.101/233	3	Serie "06", "07", "DX", FL.912, FL.913
	(01161134) (01179700)		
FENDT	XF.201090	1	Type CAV (7/8" UNF)
FIAT (NEW-HOLLAND)	SF.4232051	2	Type CAV
	(4176086, 5141702)		
	SF.000202 (12V)	4	Anciens modèles
	SF.975331 (24V)	4	Anciens modèles
FORD (NEW-HOLLAND)	FC.5/9546AA	2	2000, 2310, 2600, 2610, 2910, 3000, 3600, 3610, 3900, (81806046) 3910, 4000, 4100, 4110, 4600, 4610, 5000, 5110, 5600, (C5NE9A436A) 5610, 5700, 5900, 6410, 6600, 6610, 6700, 6710, 6810, 7000, 7410, 7600, 7610, 7610S, 7700, 7710
JOHN DEERE	JD.26190	1	Suivant montage
	26/63103AR	2	
MASSEY-FERGUSON	M.1854104	2	FE.35/ 4 cyl.
	M.1854050	1	7/8" Perkins 3.152, 4.192, 4.203, 4.212, 4.236, (2666103) 4.248, 6.305, 6.354
	30/60-3	2	7/8" Perkins 3152, 4.192, 4.203, 4.212, 4.236, (1446935M1, 2666108) 4.248, 6.305, 6.354
	M.1854125	2	7/8", modèles 3000, 6000, 8000 mot. Turbo (893501M91, 3637651M1)
RENAULT-DMA	RR.41171	1	Modèle "CAV" (7/8" UNF) (MWM & Perkins)
SAME-LAMBORGHINI- HÜRLIMANN	S.7659/013	3	Modèle "BOSCH"
	S.7659/007	2	Modèle "CAV"
VALMET	10/344	1	Moteurs Turbo
MOISSONEUSE- BATTEUSE	ET375	2	Moteurs Turbo

POMPE D'AMORCAGE POUR MOTEURS DIESEL



447222 - Pompe d'amorçage
(Filetage M.16 x 150)

Pour systèmes "BOSCH", "C.A.V.", "SPICA" etc..

**BEPCO PARTS SA****HERMALLE-SOUS-HUY**

Rue Chaumont, 4D • 4480 Hermalle-sous-Huy • Belgique
 T +32 85 24 54 00 • F +32 85 24 54 50
 info.be@becoparts.com • www.becoparts.com

VILLERS-LE-BOUILLET

Rue de Waremme, 114 • 4530 Villers-le-Bouillet • Belgique
 T +32 85 24 54 00 • F +32 85 24 54 50
 info.be@becoparts.com • www.becoparts.com

**BEPCO UK LTD**

Bepco House • Unit 316 • Hartlebury Trading Estate
 Hartlebury - Worcestershire, DY10 4JB (UK)
 P +44 (0)1299 252270 • F 0800 216553
 info@becoparts.com • www.becoparts.com

**BEPCO FRANCE SAS**

Z.I. La Plaine, Allée de Bigorre
 BP80041 Le Passage • 47901 Agen Cedex 9 • France
 T +33 (0)553 96 31 25 • F +33 (0)553 68 03 72
 info.fr@becoparts.com • www.becoparts.com

VILLENEUVE-SUR-LOT

294 Av. de Bordeaux • CS 30059 Bias
 FR-47302 Villeneuve sur lot • France
 T +33 (0)5 53 40 37 50 • F +33 (0)5 53 70 61 93

JANZÉ

P.A. de la Chauvelière • Rue Charles Lindbergh
 35150 JANZE • France
 T + 33 (0)2 99 44 16 18 • F +33 (0)2 99 44 17 29

**TVH AUSTRALASIA PTY LTD**

HEAD OFFICE BRISBANE • www.becoparts.com

ADELAIDE

96 South Terrace • Wingfield SA 5013
 Free 1800 182 344 • T +61 8 8359 8933 • F +61 8 8234 2212
 BepcoSAsales@tvh.com.au

BRISBANE

735 Boundary Road • Richlands QLD 4077
 Free 1800 020 082 • T +61 7 3344 1113 • F +61 7 3344 1332
 BepcoQLDsales@tvh.com.au

MELBOURNE

7/66-74 Micro Circuit • Dandenong South VIC 3175
 Free 1800 802 367 • T +61 3 9796 5422 • F +61 3 9796 5251
 BepcoVICsales@tvh.com.au

PERTH

2/15 Colin Jamieson Drive • Welshpool WA 6106
 Free 1800 182 344 • T +61 8 8352 8984 • F +61 8 8234 2212
 BepcoWAsales@tvh.com.au

SYDNEY

1/1002-1010 Canley Vale Rd • Wetherill Park NSW 2164
 Free 1800 808 827 • T +61 2 6885 5288 • F +61 3 9796 5251
 BepcoNSWsales@tvh.com.au

**TVH NEW ZEALAND LTD****AUCKLAND**

PO Box 51490 • Pakuranga 2140 • 11K Echelon Place
 East Tamaki • Auckland
 Free 0800 459 662 • T +64 9 274 9695 • F +64 9 274 9698
 info@tvh.co.nz • www.tvh.com

CHRISTCHURCH

11C Parkhouse Road
 Wigram • Christchurch 8042
 Free 0508 8 722 867 • T +64 3 550 1298 • F +64 3 974 9993
 infochch@tvh.co.nz

**BEPCO DEUTSCHLAND GmbH**

Neuer Weg 5 • 59505 Bad Sassendorf • Germany
 T +49 (0)2927 919 59 0 • F +49 (0)2927 919 59 59
 info.de@becoparts.com • www.becoparts.com

**BEPCO NEDERLAND BV**

Den Dolvert 10 • 5473 GP, Heeswijk-Dinther • Nederland
 T +31 (0)413 29 39 75 • F +31 (0)413 29 40 87
 info.nl@becoparts.com • www.becoparts.com

**BEPCO IBÉRICA SA**

Pol. Ind. Les Guixeres, C/ Xarol, 7
 08915 Badalona (Barcelona) • Spain
 T +34 (0)902 111 062 - 933 810 062 • F +34 (0)933 813 345
 info.es@becoparts.com • www.becoparts.com

ALMENDRALEJO

Ctra. Badajoz - Pol. «Rayvaz» Nave 21
 06200 Almendralejo (Badajoz)
 T +34 (0)902 111 062 - 924 664 890
 F +34 (0)924 664 576

DOS HERMANAS

Pol. Ind. La Isla, C/ Hornos, 11
 41703 Dos Hermanas (Sevilla)
 T +34 (0)902 111 062 - 954 931 546
 F +34 (0)954 930 130

SANTIAGO DE COMPOSTELA

Pol. El Tambre, Via Faraday, 36
 15890 Santiago de Compostela
 T +34 (0)902 111 062 - 981 560 012
 F +34 (0)981 557 753

**TVH PARTS SOUTH AFRICA (Pty) Ltd**

HEAD OFFICE JOHANNESBURG • www.tvh.com

CAPE TOWN

1 Karee Street • Kraaifontein Industries • Cape Town 7571
 T +27 21 988 2432 • F +27 21 988 9127
 capetownsales@tvh.com

DURBAN

2 Monaco Place • Westmead • Pinetown 3600
 T +27 31 100 0760 • F +27 31 700 6191
 durbansales@tvh.com

JOHANNESBURG

90 Electron Avenue • Isando • Kempton Park 1601
 T +27 11 281 27 00 • F +011 974 9845
 johannesburgsales@tvh.com

LICHTENBURG

Shop 1 • 109 Scholtz Street • Lichtenburg 2740
 T +27 18 632 6192/6092 • F +27 18 632 6108
 lichtenburgsales@tvh.com

PORT ELIZABETH

134 Kempston Road • Korsten • Port Elizabeth 6020
 T +27 41 453 1404/8 • F +27 41 453 1409
 portelizabethsales@tvh.com

FOR ALL OUR LATEST CATALOGUE UPDATES AND COMPANY INFO: WWW.BEPCOPARTS.COM



The spare parts mentioned in this list can normally be delivered from stock. In addition, we can supply parts, which are not mentioned in this catalogue, with the shortest possible delivery time. The O.E.M. references are only for indication purposes and do not imply that the spare parts are coming from the manufacturer. This spare parts list can be modified without prior notice. All photographs, drawings, illustrations, brand names, descriptions and numbers are included for identification purposes only.



De onderdelen vermeld in deze lijst, zijn normaal uit voorraad leverbaar, behoudens uitverkocht. Ook niet-vermelde onderdelen kunnen binnen de kortste tijd uitgeleverd worden. De O.E.M. referenties dienen enkel ter indicatie en impliceren niet dat deze van de vermelde constructeur afkomstig zijn. Deze onderdelenlijst kan zonder enige voorafgaande verwittiging aangepast worden. Alle gebruikte foto's, tekeningen, afbeeldingen, merknamen, omschrijvingen en nummers dienen alleen ter identificatie.



Les pièces de rechange, mentionnées dans cette liste, sont normalement livrables du stock. En plus, les articles non indiqués peuvent être fournis en peu de temps. Cette liste peut être modifiée sans avis préalable. Les références O.E.M. sont seulement indicatives et n'impliquent pas que les pièces de rechange viennent du constructeur. Toutes les photographies, illustrations, marques, descriptions, tous les plans et numéros servent exclusivement à une identification.



Die in dieser Liste aufgeführten Teile sind normalerweise aus dem Lager lieferbar. Wir sind zudem in der Lage nicht aufgeführte Teile innerhalb kürzester Zeit zu liefern. Die O.E.M. Referenznummern dienen zur Information und beinhalten nicht, dass diese vom genannten Hersteller kommen. Diese Bestandsliste kann ohne vorhergehende Ankündigung geändert werden. Alle verwendeten Foto's, Zeichnungen, Abbildungen, Markennamen, Beschreibungen und Nummern dienen nur zu Identifikationszwecken.



Los artículos mencionados en este catálogo se encuentran habitualmente en stock. Además, podemos suministrar en un plazo corto de tiempo otros artículos relacionados que no se encuentren expresamente mencionados en este catálogo. Las referencias O.E.M. sirven sólo como indicación y no implican que procedan del constructor. Este listado de productos puede estar sujeto a modificaciones sin aviso previo. Todas las fotos, dibujos, ilustraciones, nombres de marca, descripciones y números se han incluido simplemente con el propósito de su identificación.



I pezzi di ricambio, menzionati in questo listino, possono essere forniti con una consegna immediata a condizione che non siano esauriti. I pezzi di ricambio non menzionati possono essere forniti in poco tempo. Le referenze O.E.M. sono solamente indicative e non implicano che i pezzi di ricambio vengano da questo costruttore. Questa lista ricambi può essere aggiustata senza avvisi anticipati. Tutti i numeri, codici, nomi, foto, spaccati e disegni sono solo a titolo informativo.



Części z tego katalogu są zazwyczaj na stanie magazynowym. Również części które nie są wyszczególnione w katalogu mogą być dostarczone na zamówienie w najkrótszym możliwym terminie. Opis części O.E.M. jest używany informacyjnie i nie wskazuje na to, że dany produkt jest wyprodukowany przez podanego producenta. Zawartość katalogu może ulec zmianie bez wcześniejszego informowania o tym. Wszystkie użyte zdjęcia, rysunki, nazwy marek, opis i numery służą tylko do identyfikacji.



Запчасти из настоящего списка, как правило, имеются в запасе, если только он не распродан. Прочие, не фигурирующие в списке артикулы, могут быть поставлены в самые кратчайшие сроки. Указание оригинальных номеров производителя не предполагает обязательного оригинального происхождения самих деталей. Данный список может изменяться без предварительного уведомления. Все использованные фото, рисунки, иллюстрации, названия брендов, наименования и номера служат исключительно для цели идентификации.

Visit us on the Internet:
www.bepcoparts.com

© **bepco** 2015

All rights reserved. No part of this catalogue may be reproduced or communicated in any form or by any means, electronic or mechanical, including copying, recording or use in an information storage or retrieval system, without prior and explicit permission of BEPCO PARTS.

- BEPCO is a supplier of after-market spare parts and accessories that are suitable for the maintenance and repair of OEM-equipment. OEM references and brands are purely indicative and do not imply that the accessories and/or spare parts are coming from the original equipment or parts manufacturer.
- Products that do not comply with regulatory requirements concerning CE conformity are not placed on the market in the European Economic Area.
- BEPCO® are registered trademarks.
- All sales are subject to the general terms & conditions of sale on www.bepcoparts.com
- Photographs and illustrations are included for reference purposes only. Printing errors reserved.

Spare parts ■ ————— ■
from A-Z for
all brands

Case IH
David Brown
Fendt
Ford
Fiat
Hürlimann
JCB
John Deere
K.H.D. (Deutz)
Kubota
Landini
Lamborghini
Manitou
Massey Ferguson
Mc Cormick
Merlo
New Holland
Renault
Same
Steyr
Valmet
Zetor

moving forward in every field



HEAD OFFICE

Rue Chaumont 4D • 4480 Hermalle-sous-Huy • Belgium
T +32 (0)85 24 54 00 • F +32 (0)800 23 132 • info.be@bepcoparts.com • www.bepcoparts.com

Member of **TVH** 